

Zoomed in View

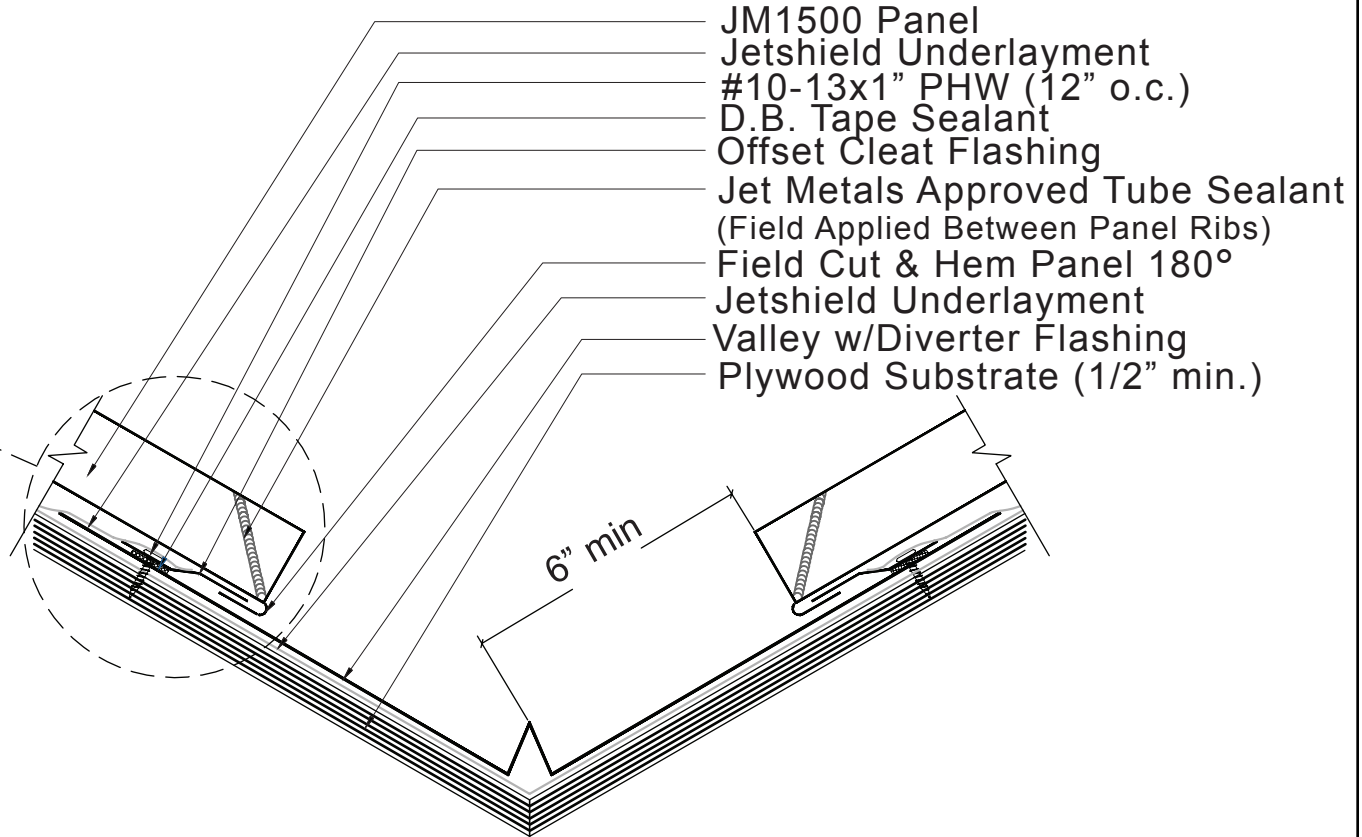

Plywood Substrate

JET METALS, LLC.

DRAWING NAME:

**JM1500 VALLEY
w/Diverter**

REV: 0	DRAWING NUMBER:	A	SHEET: 1 of 1
-----------	-----------------	----------	------------------

DATE: 06/01/2015	DRAWN BY: Off Balance Digital Art	PAINT:
---------------------	--------------------------------------	--------

NOTE:

- 1.) Laps in Valley are 12" min.
Jet Metals approved tube sealant in all Laps in Valley
Two rows of sealant between Valley Laps, 4" up from Lap.

NOTE:

- 2.) Large roof areas mat require a larger gap between panel and diverter to allow for storm water run off.