

Zoomed in View

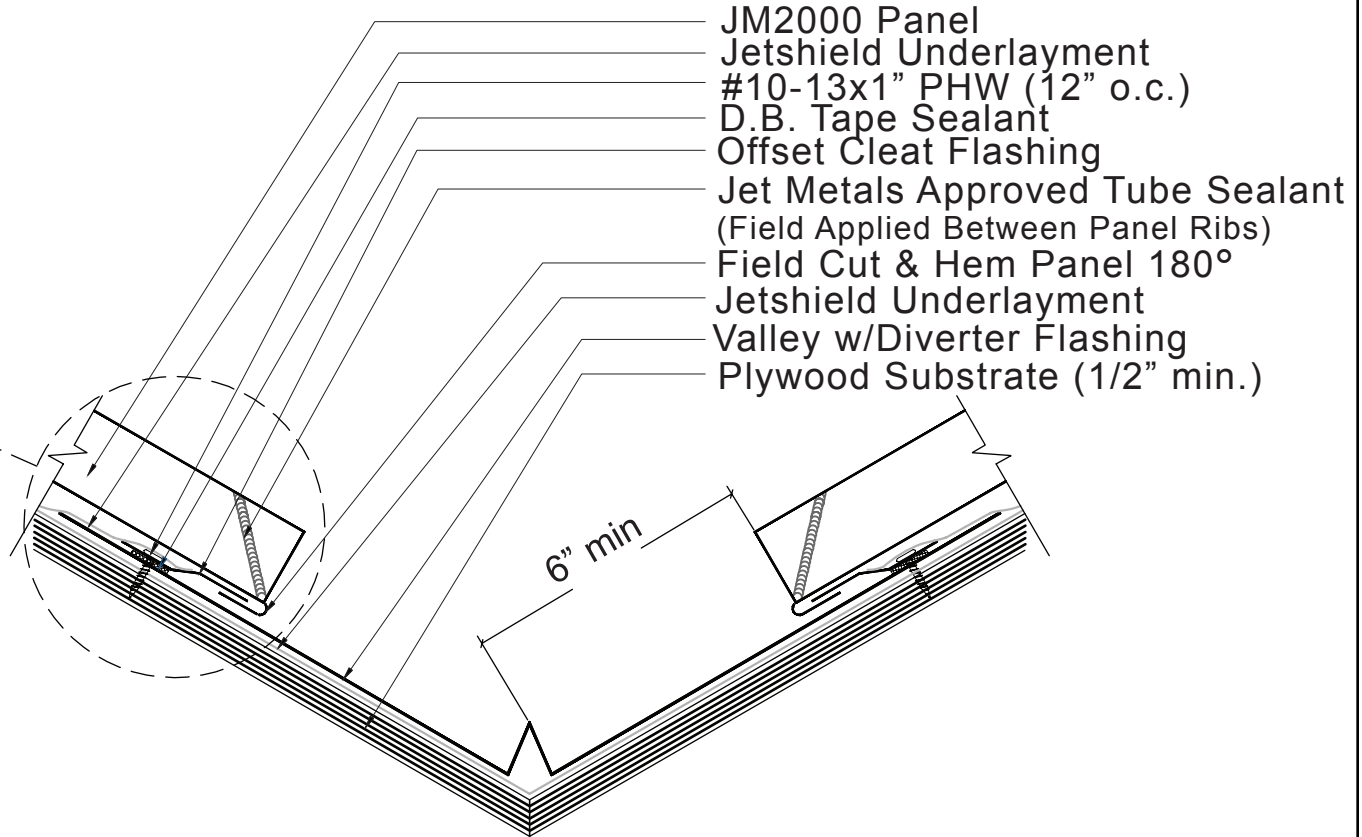

Plywood Substrate

**JET METALS, LLC.**

DRAWING NAME:  
**JM2000 VALLEY  
w/Diverter**

REV: 0	DRAWING NUMBER:	<b>A</b>	SHEET: 1 of 1
DATE: 06/01/2015	DRAWN BY: Off Balance Digital Art	PAINT:	

**NOTE:**

- 1.) Laps in Valley are 12" min.  
Jet Metals approved tube sealant in all Laps in Valley  
Two rows of sealant between Valley Laps, 4" up from Lap.

**NOTE:**

- 2.) Large roof areas mat require a larger gap between panel and diverter to allow for storm water run off.