

# COMMERCIAL JAMB TRIM JET-112

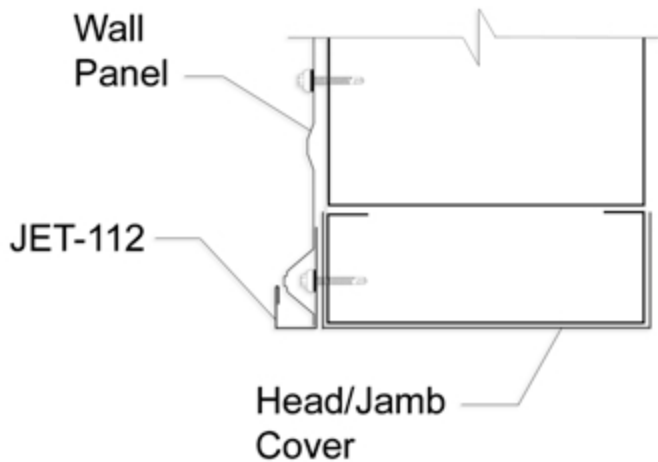

**NOTES:**

1. ALL ANGLES TO BE 90° UNLESS OTHERWISE SPECIFIED
  2. ALL RADIUS TO BE 1/16" UNLESS OTHERWISE SPECIFIED.
  3. ALL HEMS TO BE CLOSED UNLESS OTHERWISE SPECIFIED.
- BLANK SIZE - .023, .019, .015, X 3" +0 -1/16"  
 MATERIAL LENGTH TO BE 120" +/- 1/4" UNLESS OTHERWISE SPECIFIED..

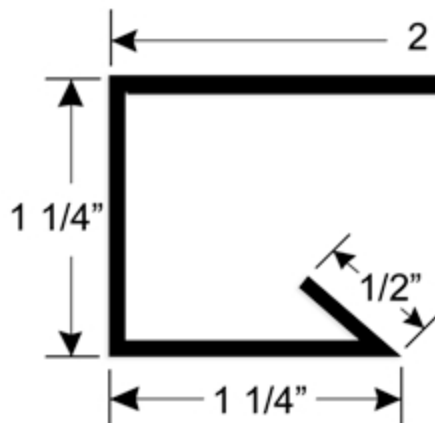
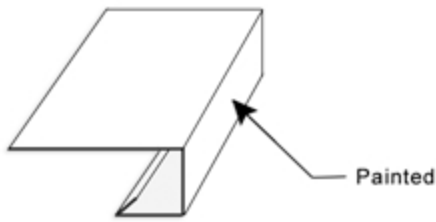

## JET METALS, L.L.C.

DRAWING NAME: <b>JET-112 Jamb Trim</b>		Tolerances: Fractional +0 -1/16"    Angles +/- 3° Twist/Ski 1/8" in 3ft Straightness/Camber 1/4" in 10ft	
SHEET: 1 of 1	A	DRAWING NUMBER: JET-112	REV: 0
PAINT:	DRAWN BY: Off Balance Digital Art		DATE: 03/10/07